

Versatile connectivity

These projectors provide a wealth of connectivity options. You can connect a variety of devices, to support all your projection needs. From DVD players and PCs to a wireless network, a Local Area Network or a simple mouse connection, Hitachi has done everything possible to ensure easy versatile connections that make your projector do more for you.



HDMI input

HDMI provides completely digital connections, ensuring that lessons and presentations can be delivered with the highest image quality.

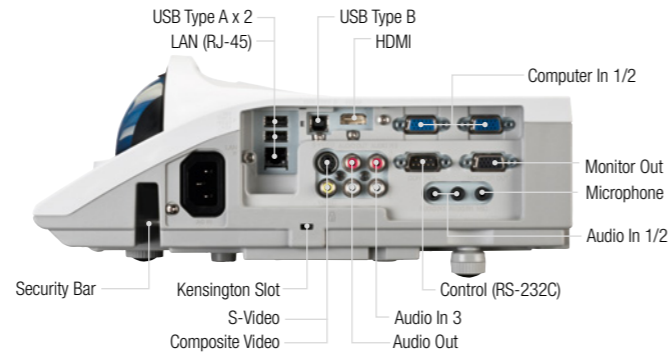

MODEL	CP-D27WN	CP-DW25WN
OPTICAL		
Resolution	XGA (1024 x 768)	WXGA (1280 x 800)
White light output (brightness)	2700 ANSI Lumens (Normal Mode)/1800 ANSI Lumens (Eco Mode)	2500 ANSI Lumens (Normal Mode)/1600 ANSI Lumens (Eco Mode)
Colour light output (colour brightness)	2700 ANSI Lumens (Normal Mode)/1800 ANSI Lumens (Eco Mode)	2500 ANSI Lumens (Normal Mode)/1600 ANSI Lumens (Eco Mode)
Contrast ratio	3000:1	3000:1
Lens	Manual focus, Digital zoom x 1.35	Manual focus, Digital zoom x 1.2
Lamp life	3000 Hours (Normal Mode)/5000 Hours (Eco Mode)*	3000 Hours (Normal Mode)/5000 Hours (Eco Mode)*
Focus distance	0.51m-0.913m (Wide)	0.547m-0.972m (Wide)
Distance to width ratio (:1)	0.4:1	0.4:1
Diagonal display size	60"-100" (152cm-254cm)	60"-100" (152cm-254cm)
Keystone	11:-1 upward shift, fixed	5.5:-1 upward shift, fixed
COMPATIBILITY		
Computer compatibility	IBM Compatible VGA, SVGA, XGA, WXGA, WXGA+, SXGA, SXGA+, UXGA (compressed), MAC 16"	IBM Compatible VGA, SVGA, XGA, WXGA, WXGA+, SXGA, SXGA+, UXGA (compressed), MAC 16"
Composite/S-video	NTSC, PAL, SECAM, PAL-M, PAL-N, NTSC4.43	NTSC, PAL, SECAM, PAL-M, PAL-N, NTSC4.43
Component video/HDMI video	525i(480i), 525p(480p), 625i(576i), 1125i(1080i@50/60), 1125p(1080p@50/60), 750p(720p@50/60)	525i(480i), 525p(480p), 625i(576i), 1125i(1080i@50/60), 1125p(1080p@50/60), 750p(720p@50/60)
FEATURES		
Speaker	10W x 1 Mono	10W x 1 Mono
Basic functions	Freeze, Magnifying, Blank, Auto adjustment, Search, Page Up & Down (for USB mouse function), Auto signal search, Auto eco mode	Freeze, Magnifying, Blank, Auto adjustment, Search, Page Up & Down (for USB mouse function), Auto signal search, Auto eco mode
Picture adjustments	Aspect selection (video, data, HDMI), Equalizing Digital Gamma Correction, Equalizing Color temperature adjustment, 2-3 pull down for NTSC, Mirror reverse image, up-side down image, Progressive Scan, Noise Reduction, Overscan	Aspect selection (video, data, HDMI), Equalizing Digital Gamma Correction, Equalizing Color temperature adjustment, 2-3 pull down for NTSC, Mirror reverse image, up-side down image, Progressive Scan, Noise Reduction, Overscan
Digital keystone	Vertical ±5° (XGA@60Hz)	Vertical ±5° (WXGA@60Hz)
Advanced features	MyScreen, My Memory, My Button, My Text, My Source, Picture mode (normal, cinema, dynamic, blackboard, whiteboard greenboard, photo), Daytime Mode, Input Source Naming (English), Resolution setting, Template, Closed Caption (for NTSC & component 480i only), Audio pass through, Framelock, Audio ports assign, Cloning, Drawing function (Optional wireless pen tablet TB-1 is necessary), Eco Mode (Normal, Eco, Intelligent eco, Saver), iOS Connectivity, ImageCare™	MyScreen, My Memory, My Button, My Text, My Source, Picture mode (normal, cinema, dynamic, blackboard, whiteboard greenboard, photo), Daytime Mode, Input Source Naming (English), Resolution setting, Template, Closed Caption (for NTSC & component 480i only), Audio pass through, Framelock, Audio ports assign, Cloning, Drawing function (Optional wireless pen tablet TB-1 is necessary), Eco Mode (Normal, Eco, Intelligent eco, Saver), iOS Connectivity, ImageCare™
Outward	Easy lamp replace from top, Air filter slides towards top	Easy lamp replace from top, Air filter slides towards top
Power on & off	Direct on, Auto off	Direct on, Auto off
Security systems	Security bar, PIN-Lock, MyScreen Password, Key Lock (key pad and remote control), Kensington slot, Transition detector, My Text Password, Security label	Security bar, PIN-Lock, MyScreen Password, Key Lock (key pad and remote control), Kensington slot, Transition detector, My Text Password, Security label
Network	Network presentation (PC still/moving picture transfer), Configure and control projector via web browser, receive alerts via e-mail, projector management via SNMP, Crestron RoomView®, Scheduling, My Image, displaying text data transferred via the network, Command Control via network, AMX Device Discovery, PJ Link™, Network Bridge	Network presentation (PC still/moving picture transfer), Configure and control projector via web browser, receive alerts via e-mail, projector management via SNMP, Crestron RoomView®, Scheduling, My Image, displaying text data transferred via the network, Command Control via network, AMX Device Discovery, PJ Link™, Network Bridge
OSD language options	English, French, German, Spanish, Italian, Norwegian, Dutch, Japanese, Simplified Chinese, Traditional Chinese, Korean, Swedish, Russian, Finnish, Polish, Turkish, Arabic, Persian, Czech, Danish, Hungarian, Romanian, Slovenian, Croatian, Greek, Lithuanian, Estonian, Latvian, Thai, Portuguese (Brazil), Indonesian, Vietnamese	English, French, German, Spanish, Italian, Norwegian, Dutch, Japanese, Simplified Chinese, Traditional Chinese, Korean, Swedish, Russian, Finnish, Polish, Turkish, Arabic, Persian, Czech, Danish, Hungarian, Romanian, Slovenian, Croatian, Greek, Lithuanian, Estonian, Latvian, Thai, Portuguese (Brazil), Indonesian, Vietnamese
CONNECTIONS		
Digital input	1 x HDMI (HDCP compatible)	1 x HDMI (HDCP compatible)
Computer input	2 x 15-pin Mini D-sub	2 x 15-pin Mini D-sub
Monitor output	1 x 15-pin Mini D-sub	1 x 15-pin Mini D-sub
Video input	2 x 15-pin Mini D-sub (shared with analogue computer in 1/2), 1 x RCA for composite, 1 x Mini-DIN for S-Video	2 x 15-pin Mini D-sub (shared with analogue computer in 1/2), 1 x RCA for composite, 1 x Mini-DIN for S-Video
Audio input	2 x Stereo Mini Jack, 1 x pair RCA (L/R), 1 x Microphone Jack	2 x Stereo Mini Jack, 1 x pair RCA (L/R), 1 x Microphone Jack
Audio output	1 x pair RCA (L/R)	1 x pair RCA (L/R)
USB	2 x USB Type A, 1 x USB Type B	2 x USB Type A, 1 x USB Type B
Control	1 x 9-pin D-sub for RS-232C control	1 x 9-pin D-sub for RS-232C control
Wired network	1 x RJ-45	1 x RJ-45
Wireless network	Option, IEEE 802.11 b/g/n ready (optional wireless adapter required)	Option, IEEE 802.11 b/g/n ready (optional wireless adapter required)
POWER		
Power supply	100-120V/220-240V, auto switching	100-120V/220-240V, auto switching
Power consumption/standby	300W/<0.35W (AC 220-240V)	300W/<0.35W (AC 220-240V)
PHYSICAL		
Dimensions (W x H x D)	345 x 85 x 303mm (excluding feet and extrusions)	345 x 85 x 303mm (excluding feet and extrusions)
Weight	3.7Kg	3.7Kg
Noise level	CP-D27WN: 28dB (Eco Mode)/35dB (Normal Mode)/ CP-DW25WN: 28dB (Eco Mode)/34dB (Normal Mode)	CP-D27WN: 28dB (Eco Mode)/35dB (Normal Mode)/ CP-DW25WN: 28dB (Eco Mode)/34dB (Normal Mode)
Air filter	Hybrid (up to 4000 hours)	Hybrid (up to 4000 hours)
MISCELLANEOUS		
	Indicator lights (lamp, temp, power), Ceiling mount image, Rear projection image, Serial number label on side, MAC PC support: PJ Control software, MAC address label on front, LiveViewer software	Indicator lights (lamp, temp, power), Ceiling mount image, Rear projection image, Serial number label on side, MAC PC support: PJ Control software, MAC address label on front, LiveViewer software
ACCESSORIES SUPPLIED		
	Remote control with batteries (HL02881), Computer cable, Power cord, Lens cap, Security label, Adapter cover, User manual (detail & concise), Application CD	Remote control with batteries (HL02881), Computer cable, Power cord, Lens cap, Security label, Adapter cover, User manual (detail & concise), Application CD
OPTIONAL ACCESSORIES		
Replacement lamp/lamp Wattage	DT01381/215W UHP	DT01381/215W UHP
USB wireless adapter	USB-WL-11N	USB-WL-11N
Solution products	TB-1 wireless interactive tablet, IM-1 interactive camera unit, MS-1WL wireless multifunctional swicher/scaler	TB-1 wireless interactive tablet, IM-1 interactive camera unit, MS-1WL wireless multifunctional swicher/scaler
WARRANTY		
Projector/Lamp	3 Years/6 Months** (for education and extended warranties, please contact your local dealer)	3 Years/6 Months** (for education and extended warranties, please contact your local dealer)

CP-D27WN CP-DW25WN

Super Short Throw LCD Projectors

Affordable solutions for business and education



Follow us:



@HitachiAV



Compatible with
Projector Quick Connection App

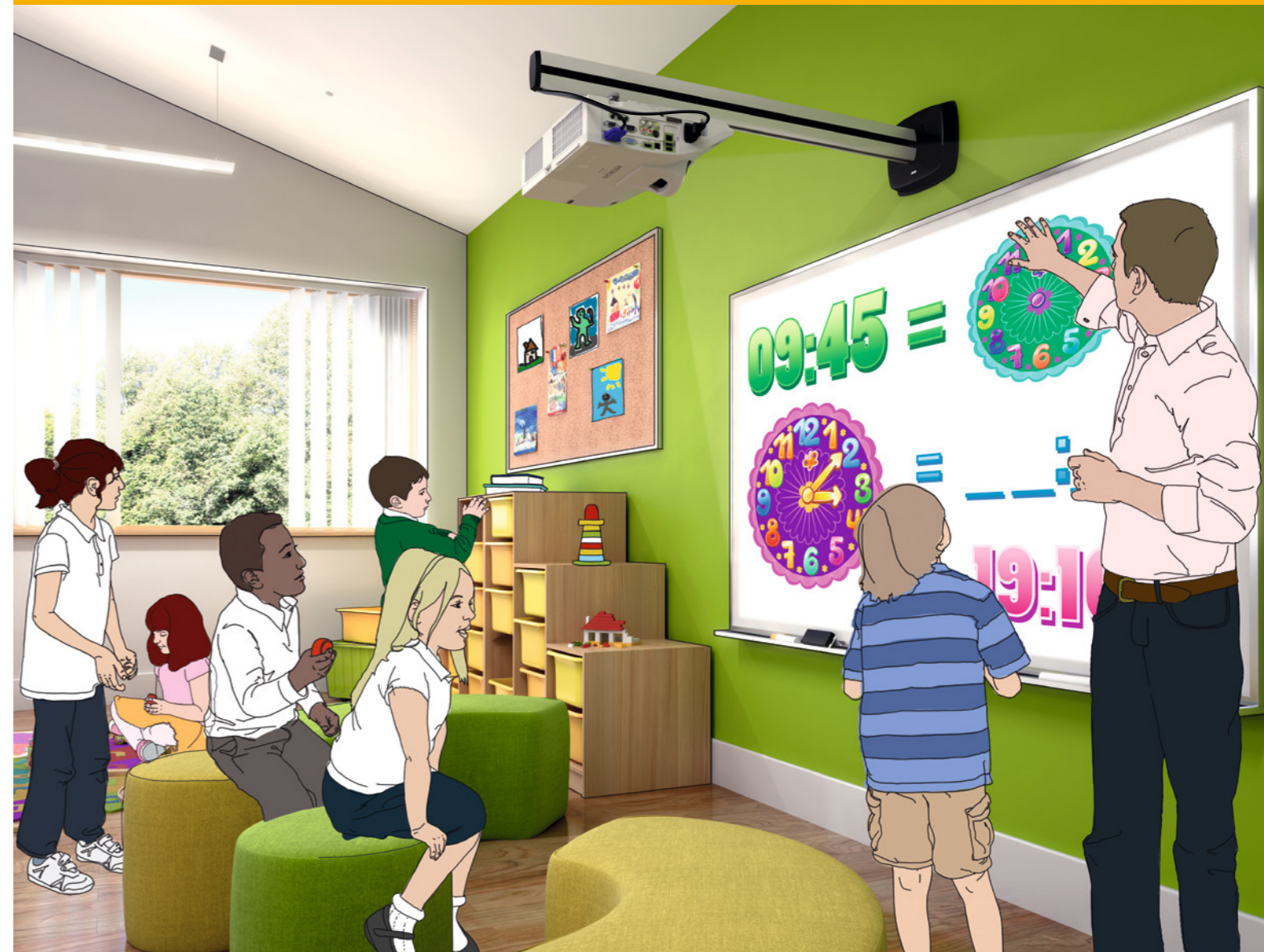

HITACHI DIGITAL MEDIA, Hitachi Europe Ltd, Whitebrook Park, Lower Cookham Road, Maidenhead, Berkshire SL6 8YA UNITED KINGDOM
Tel: +44 (0)1628 585 000 Fax: +44 (0)1628 585 163 www.hitachidigitalmedia.com

*The stated lamp and filter life refers to the average life expected in ideal operating conditions with usage in accordance with the manual. The majority of, but not all lamps and filters should achieve this figure. **Where a lamp fails within warranty and a replacement lamp is taken, the warranty for the replacement lamp will be a maximum of 6 months (dependent on warranty hours stated). HDMI, the HDMI logo and High-Definition Multimedia Interface are trademarks or registered trademarks of HDMI Licensing LLC. AMX and the AMX logo, and Device Discovery are all registered trademarks of AMX. The specification above and photography is for reference only and may be subject to change.



HITACHI
Inspire the Next

www.hitachidigitalmedia.com

Project large, bright images in tight spaces with Hitachi Super Short Throw Projectors

These lightweight and compact projectors are perfect for small and medium sized meeting rooms and can deliver an impressive 80" image from a distance of only 75cm. They are easy to install and flexible to use with optional wireless networking, providing an affordable solution for business and education settings.

What is Super Short Throw?

Super Short Throw projectors enable users to conduct effective lessons and presentations without being affected by the projector's light source, allowing audiences to concentrate on the content without being distracted by shadows. These projectors use their unique lens design to produce large images from class-leading short distances.

A Super Short Throw projector can project a 2.0m (80") image from a distance of only 75cm*. This provides the optimum balance between extremely short throw distances of Ultimate Short Throw projectors and the affordability of standard short throw models. This is achieved through the mirror-less high quality design combined with advanced optical technology.

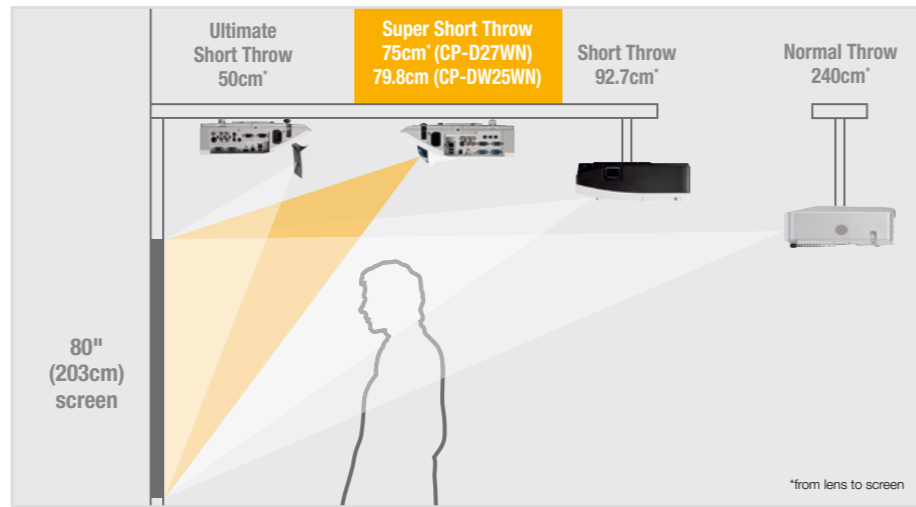

Low total cost of ownership

Eco features based on ImageCare® technology

ImageCare combines optimal picture performance with maximum energy savings. This technology has been integrated to enhance our existing industry-leading eco features. Find out how much money and energy you can save using our Energy Savings Calculator at: www.hitachidigitalmedia.com/energysavings

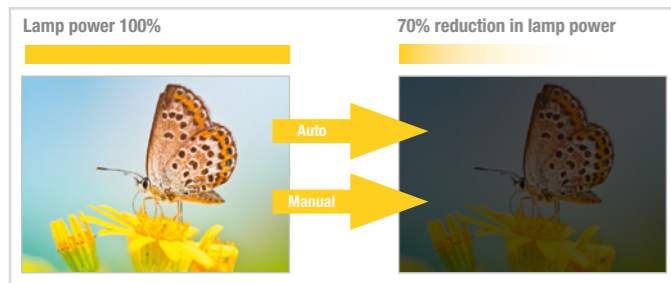

Saver Mode

The Saver Mode reduces lamp power by 70% compared to Normal Mode, resulting in considerable energy savings. You can set the time for Saver Mode from 1 to 30 minutes. If the projected image does not change within the set time, the Saver Mode is activated.

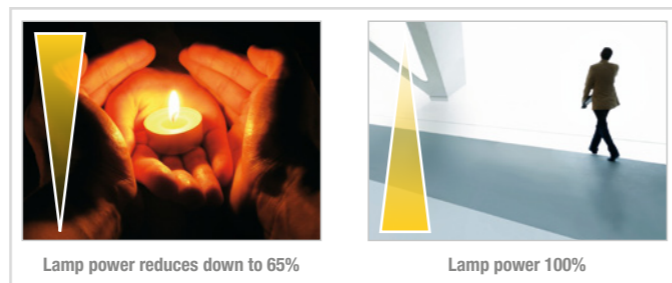

Intelligent Eco Mode

When Intelligent Eco Mode is selected, the lamp power adjusts according to screen brightness. Lamp power decreases when the image is dark and increases when the image is bright. Using Intelligent Eco Mode increases the contrast ratio of the projector while decreasing the use of electricity.

Value added features

Compatible with Hitachi Solution products

All new Super Short Throw models are fully compatible with our innovative Hitachi Solution products*, which enhance interactivity, simplify installation and easily accommodate multiple devices with complex connections. With 2 USB type A inputs both the optional wireless adapter and one of our Solution products can be used simultaneously.

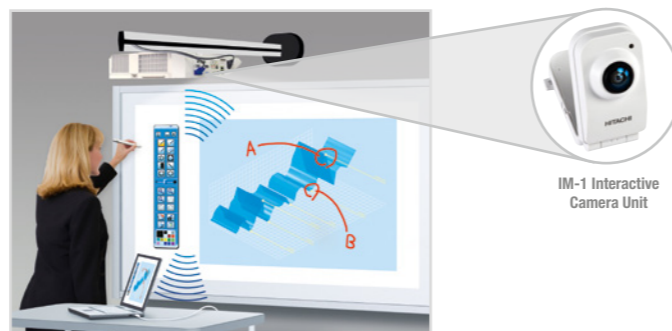

Affordable interactive solution

When combined with a Super Short Throw projector, the IM-1 provides a convenient and cost effective interactive solution. The included user-friendly software brings all the benefits of interactivity to non-interactive Hitachi projectors.

Wireless connectivity

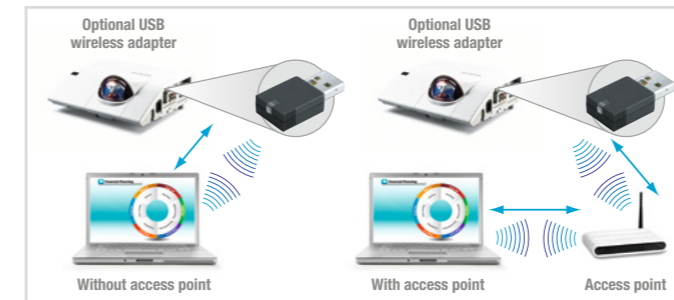

Wireless capability and network functionality

Hitachi's Super Short Throw projectors allow you to connect to your wireless network, letting you run lessons or presentations wirelessly from your laptop. The USB wireless adapter enables the projector and computer to communicate both directly or via a wireless network infrastructure. The optional USB wireless adapter supports all IEEE802.11b/g/n networks, and simply slots into place.



iOS Connectivity*

Using our 'Projector Quick Connection' application, users can wirelessly display documents, images and web pages from their iPad®, iPod touch® and iPhone® on all of our Super Short Throw projectors. The application allows users to control the projector via their iOS devices. *Our 'Projector Quick Connection' application can be downloaded from the App Store™. Available using the following file formats: jpg, bmp, png, gif, PDF, Excel®, Word®, PowerPoint®, Keynote®, Numbers®, Pages® and Web pages.

Usability features

Template function

Hitachi's CP-D27WN and CP-DW25WN come equipped with handy pre-installed templates that allow you to project lines, grids and maps onto a whiteboard, blackboard or flip chart making drawing and writing easier.

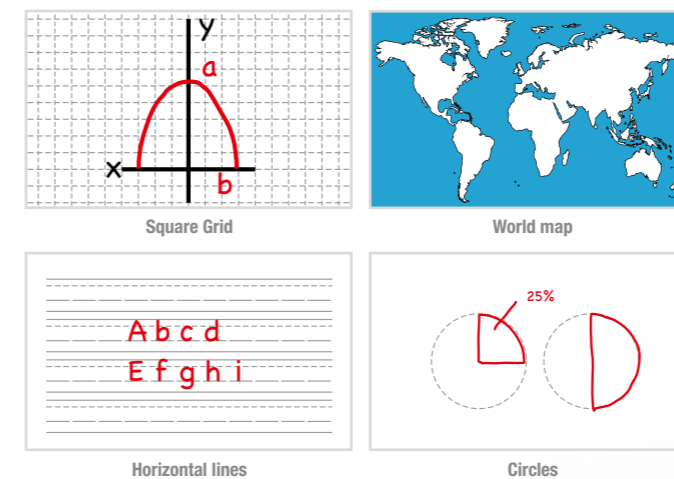

Network presentations

You can project still or moving images from one or more networked computers. Single PC mode allows one computer on the network to be displayed, a useful feature for classroom and meeting rooms environments. Multi PC mode is perfect for comparing work, as up to four computers can be displayed simultaneously.



Cloning

Instead of setting up multiple projectors individually you can simply save the settings from one projector to a USB memory stick and apply them to other projectors you have installed, saving you valuable time. This feature is also helpful for applying MyScreen messages or logo to multiple projectors.

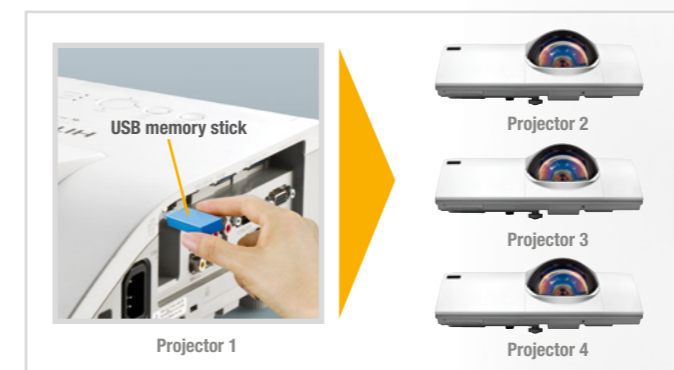

*Compatible Solution products include: Wireless Pen Tablet TB-1, Interactive Camera Unit IM-1, Wireless Multifunctional Switcher/Scaler MS-1WL. For further information and specifications please refer to our website www.hitachidigitalmedia.com.